

A MESSAGE TO HYUNDAI LIFT TRUCK OPERATORS

Lift trucks are specialized trucks with unique operating characteristics, designed to perform a specific job. Their function and operation is not like a car or ordinary truck. They require specific instructions and rules for safe operation and maintenance.

Safe operation of lift trucks is of primary importance to HYUNDAI.

Our experience with lift truck accidents has shown that when accidents happen and people are killed or injured, the causes are:

- Operator not properly trained
- Operator not experienced with lift truck operation
- Basic safety rules not followed
- Lift truck not maintained in safe operating condition

For these reasons, HYUNDAI wants you to know about the safe operation and correct maintenance of your lift truck.

This manual shows and tells you about safety inspections and the important general safety rules and hazards of lift truck operation. It describes the special components and features of the truck and explains their function. The correct operating procedures are shown and explained. Illustrations and important safety messages are included for clear understanding. A section on maintenance and lubrication is included for the lift truck mechanic.

The operator's manual is not a training manual. It is a guide to help trained and authorized operators safely operate their lift truck by emphasizing and illustrating the correct procedures. However, it cannot cover every possible situation that may result in an accident. You must watch for hazards in your work areas and avoid or correct them. It is important that you know and understand the information in this manual and that you know and follow your company safety rules!

Be sure that your equipment is maintained in a safe condition. Do not operate a damaged or malfunctioning truck. Practice safe operation every time you use your lift truck. Let's join together to set high standards in safety.

Remember, before you start operating this lift truck, be sure you understand all driving procedures. It is your responsibility, and it is important to you and your family, to operate your lift truck safely and efficiently.

△ Be aware that the Federal Occupational Safety and Health Act (OSHA) and state laws require operators be completely trained in the safe operation of lift trucks; It is also an (OSHA) requirement that a truck inspection be performed before every shift. If you need training in operating or inspecting your lift truck, ask your supervisor.

HYUNDAI lift trucks are built to take hard work, but not abuse. They are built to be dependable, but they are only as safe and efficient as the operator and the persons responsible for maintaining them. Do not make any repairs to this truck unless you have been trained in safe lift truck repair procedures and are authorized by your employer.

This manual describes procedures for operation, handling, lubrication, maintenance, checking and adjustment. It will help the operator realize peak performance through effective, economical and safe truck operation.

INTRODUCTION

HYUNDAI welcomes you to the growing group of professionals who own, operate and maintain HYUNDAI lift trucks. We take pride in the long tradition of quality products and superior value the HYUNDAI name represents. This manual familiarizes you with safety, operating, and maintenance information about your new lift truck. It has been specially prepared to help you use and maintain your HYUNDAI lift truck in a safe and correct manner.

Your HYUNDAI lift truck has been designed and built to be as safe and efficient as today's technology can make it. As manufactured, for some models, it meets all the applicable mandatory requirements of ANSI B56.1-1988 Safety Standard for Powered Industrial Trucks. Some trucks are also furnished with equipment to help you operate safely; for example, load back rest, parking brake and horn are standard equipment.

Safe, productive operation of a lift truck requires both skill and knowledge on the part of the operator. The operator must know, understand, and practice the safety rules and safe driving and load handling techniques described in this manual. To develop the skill required, the operator must become familiar with the construction and features of the lift truck and how they function, the operator must understand its capabilities and limitations, and see that it is kept in a safe condition.

Routine Servicing and Maintenance

Regular maintenance and care of your lift truck is not only important for economy and utilization reasons; it is essential for your safety. A faulty lift truck is a potential source of danger to the operator, and to other personnel working near it. As with all quality equipment, keep your lift truck in good operating condition by using quality standard parts, and following the recommended schedule of maintenance.

Operator Daily Inspection - Safety and Operating Checks

A lift truck should always be examined by the operator, before driving, to be sure it is safe to operate. The importance of this procedure is emphasized in this manual with a brief illustrated review and later with more detailed instructions. HYUNDAI dealers can supply copies of a helpful Drivers Daily Checklist. It is an OSHA requirement.

Planned Maintenance

In addition to the daily operator inspection, HYUNDAI recommends that a planned maintenance and safety inspection program (PM) be performed by a trained and authorized mechanic on a regular basis. The PM will provide an opportunity to make a thorough inspection of the safety and operating condition of your lift truck. Necessary adjustments and repairs can be done during the PM, which will increase the life of components and reduce unscheduled downtime and increase safety. The PM can be scheduled to meet your particular application and lift truck usage.

The procedures for a periodic planned maintenance program that covers inspections, operational checks, cleaning, lubrication, and minor adjustments are outlined in this manual. Your HYUNDAI dealer is prepared to help you with a Planned Maintenance Program by trained service personnel who know your lift truck and can keep it operating safely and efficiently.

Service Manual

In-depth service information for trained service personnel is found in Service Manual.

HOW TO USE THIS MANUAL

This manual is a digest of essential information about the safe operation, the features and functions and explains how to maintain your lift truck. This manual is organized into eight major parts:

Section 1. Safety hints, reviews and illustrates accepted practices for safe operation of a lift truck.

Section 2. Operating Hazards, conditions that could cause damage to the truck or injury to the operator or other personnel.

Section 3. Know Your Truck, describes the major operating components, systems, controls, and other features of your truck and tells how they function.

Section 4. Operator Maintenance and Care, presents details on how to perform the operator's daily safety inspection and refuel the lift truck.

Section 5. Starting and Operating Procedures, discusses specific instructions on the safe, efficient operation of your lift truck.

Section 6. Emergency Starting and Towing, gives instructions for towing your truck in an emergency and for using battery jumper cables to start your truck in an emergency.

Section 7. Planned Maintenance and Lubrication, describes the PM (Planned Maintenance) program.

Section 8. Specifications, provides reference information and data on features, components, and maintenance materials.

※ **The descriptions and specifications included in this manual were in effect at the time of printing. HYUNDAI reserves the right to make improvements and changes in specifications or design, without notice and without incurring obligation. Please check with your authorized HYUNDAI dealer for information on possible updates or revisions.**

The examples, illustrations, and explanations in this manual should help you improve your skill and knowledge as a professional lift truck operator and take full advantage of the capabilities and safety features of your new lift truck.

The first section of the manual is devoted to a review, with illustrations and brief messages, of general safety rules and the major operating hazards you can encounter while operating a lift truck. Next, you will find description's of the components of your specific lift truck model and how the instruments, gauges, and controls operate. Then, you will find a discussion of safe and efficient operating procedures, followed by instruction's on how to tow a disabled lift truck. The later sections of the manual are devoted to maintenance and truck specifications.

Take time to carefully read the Know Your Truck section. By acquiring a good basic understanding of your truck's features, and how they function, you are better prepared to operate it both efficiently and safely.

In Planned Maintenance, you will find essential information for correct servicing and periodic maintenance of your truck, including charts with recommended maintenance intervals and component capacities. Carefully follow these instructions and procedures.

Each major section has its own table of contents, so that you can find the various topics more easily

We urge you to first carefully read the manual from cover to cover. Take time to read and understand the information on general safety rules and operating hazards. Understand how all gauges, indicator lights, and controls function. Please contact your authorized HYUNDAI dealer for the answers to any questions you may have about your lift truck's features, operation, or manuals.

Operate your lift truck safely; careful driving is responsibilities of operator and administrator.

Drive defensively and think about the safety of people who are working nearby. Know your truck's capabilities and limitations. Follow all instructions in this manual, including all symbols (▲ △ ※) and messages to avoid damage to your lift truck or the possibility of any harm to yourself or others.

This manual is intended to be a permanently attached part of your lift truck. Keep it on the truck as a ready reference for anyone who may drive or service it. If the truck you operate is not equipped with a manual, ask your supervisor to obtain one and have it attached to the truck.

And, remember, your HYUNDAI dealer is pleased to answer any questions about the operation and maintenance of your lift truck and will provide you with additional information should you require it.

SAFETY LABELS

1. LOCATION

Always keep these labels clean. If they are lost or damaged, attach them again or replace them with new labels. If they are lost or damaged, attach them again or replace them with new labels.

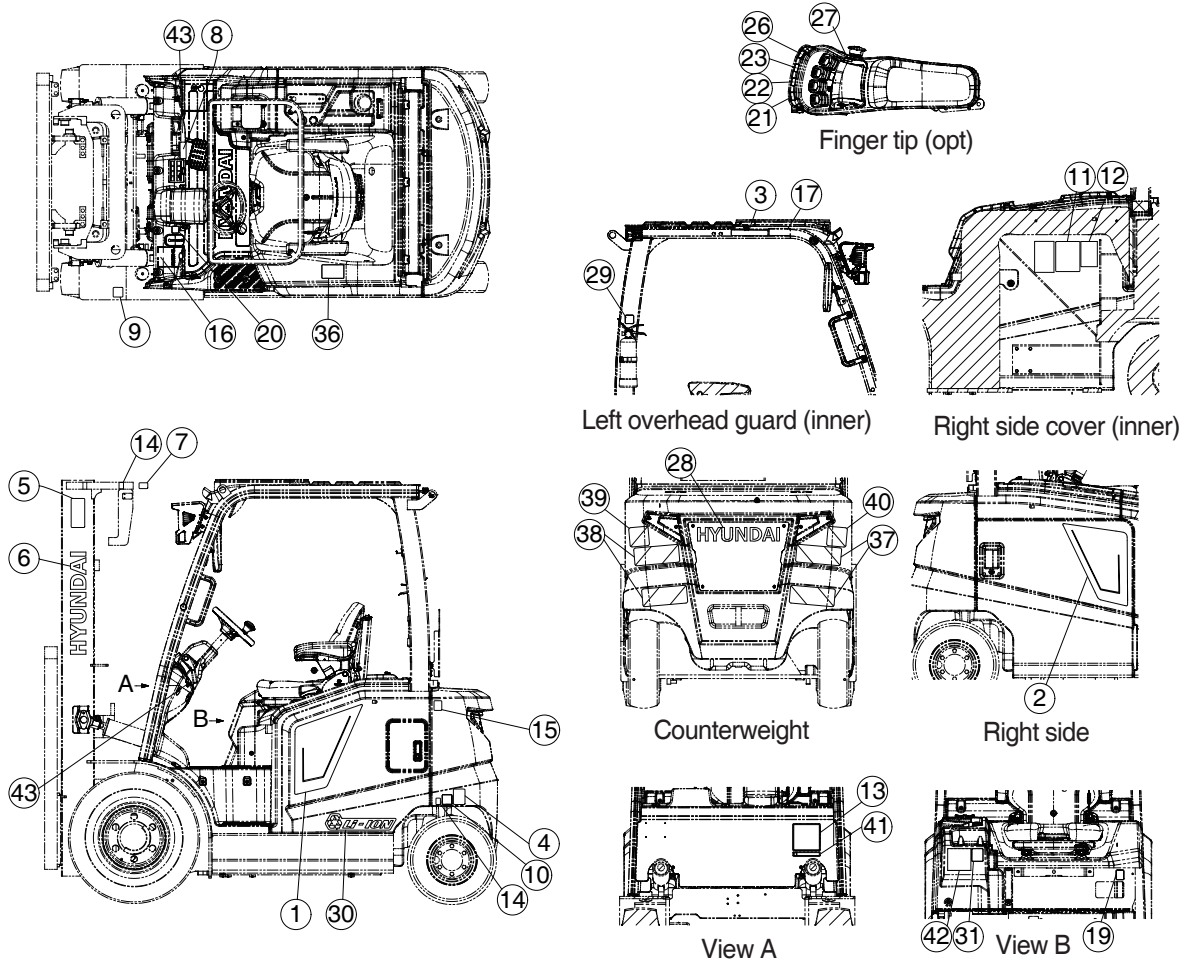

25BX0SL01AK

1 Model name	12 Battery handling caution	24 Fork positioner (fingertip)
2 Model name	13 Safety instructions	27 F&R transfer (fingertip)
3 Safety warning	14 Hook	28 HYUNDAI logo
4 Hauling	15 Temperature	29 Fire extinguisher
5 Mast warning	16 Brake oil	30 Lithium ion battery (opt)
6 HYUNDAI logo	17 Name plate	31 Seat warning
7 Hand caution	19 Hydraulic oil	36 Integrated call center
8 Start caution	20 Parking brake	41 Night road driving prohibited
9 Front tire	21 Fork lifting (fingertip)	42 System dimensions
10 Rear tire	22 Fork tilting (fingertip)	43 Solid tire
11 Maintenance checklist	23 Side shift (fingertip)	

2. DESCRIPTION

There are several specific warning labels on this truck. Please become familiarized with all warning labels. Replace any safety label that is damaged, or missing.

1) SAFETY WARNING (item 3)

This warning label is positioned on the inside of the upper left side of overhead guard.

- ① Refer to operator's manual in detail.
- ② Always buckle up the seat belt for safety operation.
- ③ When the operator get off the truck, always press the parking brake switch so that the truck can keep with stopping condition.
- ④ The people should not pass through under forks and other attachments which are lifted or being lifted.
- ⑤ Do not jump down from the truck. It can be caused that the operator have severe injury or death in the event of a tip over.
- ⑥ Outstretch the legs as widely as possible and grasp firmly the steering handle.
- ⑦ Lean the body to the opposite direction in order to avoid severe injury or death when the truck is tipped over.

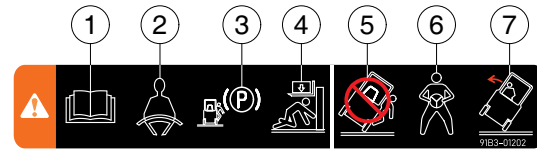

▲ Safety and warning decals are placed in conspicuous locations on the truck to remind you of essential procedures or to prevent you from making an error that could damage the truck or possibly cause personal injury. You should know, understand, and follow these instructions. Safety and warning decals should be replaced immediately if missing or defaced (Damaged or illegible). Refer to page 0-5 of this manual for the location of all decals.

▲ The purpose of the decals is to remind the operator that staying in the seat provides the best chance of avoiding injury in the event of a truck-tipping or driving off a dock mishap. Lift trucks can be tipped over if operated improperly. Experience with lift truck accidents has shown that the driver cannot react quickly enough to jump clear of the truck and overhead guard as the truck tips. To protect operators from severe injury or death in the event of a tip over, it is best to be held securely in the seat. So, please, always buckle up when driving your lift truck.

2) HAULING (item 4)

(1) This warning label is positioned on the left side of the counterweight.

⚠ Please see Page 1-21 of the manual for safe hauling.

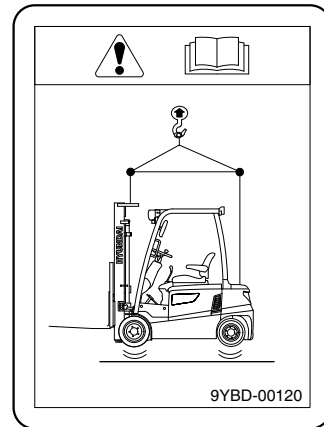

3) MAST WARNING (item 5)

This warning label is positioned on the both side of the mast.

⚠ Never stand or work under forks at any circumstances without supporting with block.

⚠ In case of working under the forks, it is essential to support the carriage with blocks.



4) HAND CAUTION (item 7)

This label is positioned on the center side of the mast cross plate.

⚠ It warns of the danger of injury from movement between rails, chains, sheaves, fork carriage, and other parts of the mast assembly. Do not climb on or reach into the mast. Personal injury will result if any part of your body is put between moving parts of the mast.

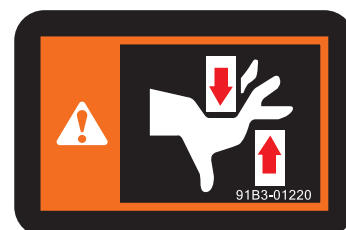

5) PARKING WARNING (item 8)

This warning and caution plate are located on the right side of the dashboard. Warnings before leaving the operator seat.

- ① Be sure to lower the attachment to the ground.
- ② Apply the parking brake.

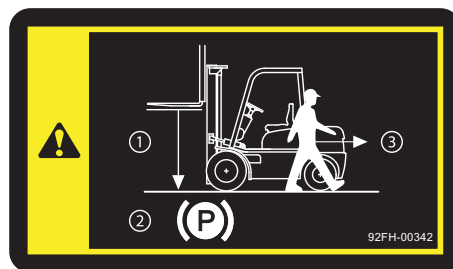

6) Tire (item 9,10)

These labels are positioned on the front top side of the left and right fender and the both rear side of the main frame.

- ※ Tire pressure must be checked in accordance with the planned maintenance chart.
- ※ Refer to page 7-17 for the regulated tire air pressure (A and B).

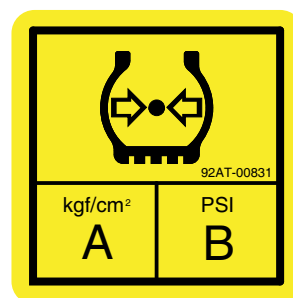

7) BATTERY HANDLING (item 12)

The decal for the battery handling is positioned on the right side inside of the cover.

- ⚠ Please see Page 7-25 of safe battery exchange.
- ※ Open the battery cover while charging the battery. Heat and inflammable hydrogen gas are generated during battery charging. Never place fire near the battery.
- ※ When raising the battery, hang ropes in two or four of the hooks, and prevent impact on the battery.
- ※ The battery electrolyte is mild sulfuric acid solution (H_2SO_4). Pay special attention to protect clothes or machine parts from contact with the solution.

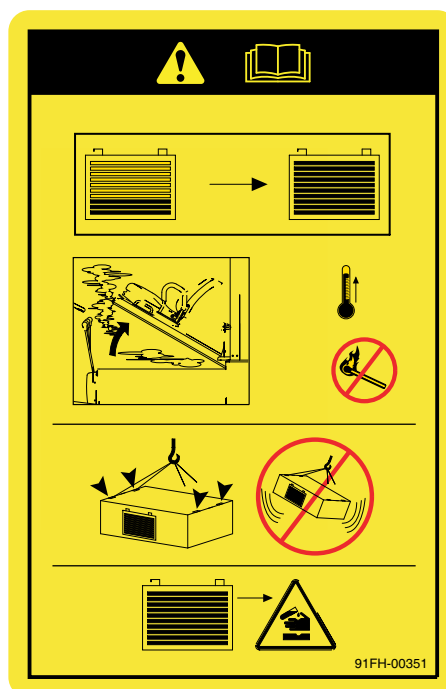

8) SAFETY INSTRUCTION (item 13)

This warning label is positioned on the outer right side of the dashboard.



9) HOOK (item 14)

This warning label is positioned on the both top side of mast and the both side of the rear fender.

⚠ Please see Page 1-21 of the manual for safe hauling procedures.



10) TEMPERATURE (item 15)

The label is positioned on the end of the left side cover.

- ⚠ Decal for working in low temperature storage is required when working in low temperature storage.
- ⚠ Continuous work inside low temperature storage should not exceed 30 minutes.
- ⚠ It is allowed to resume work in low temperature storage after standing by or operating outside low temperature storage longer than work time inside the low temperature storage.

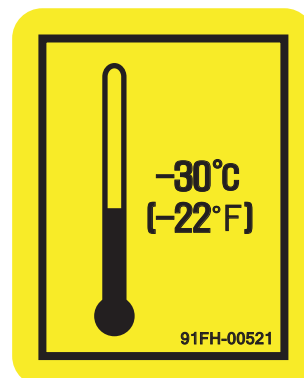

11) BRAKE OIL (item 16)

This label is positioned on the left side of the dashboard.

- ⚠ Use ISO VG32 or Azolla Z32 only for brake oil.



12) HYDRUALIC OIL (item 19)

This warning label is positioned on the bottom left side of the driver seat.

- ⚠ Fill only the hydraulic oil.
- ⚠ Do not fill the diesel oil.



13) PARKING BRAKE (item 20)

This warning decal is positioned near the parking brake lever.

- ※ When parting, fully pull the lever up.



14) FIRE EXTINGUISHER (item 29)

This warning label is positioned on the rear left side of the stay.

- ※ Read and understand the instructions adhered decal on the fire extinguisher.



3000SL02

15) SOLID TIRE (item 43)

This decal is positioned on the right side of the dashboard.

- △ Do not travel at excessively high speed with the solid tires are installed.
- ※ Do not drive on the road for automobiles.
- ※ Please see Page 2-7 for further information.

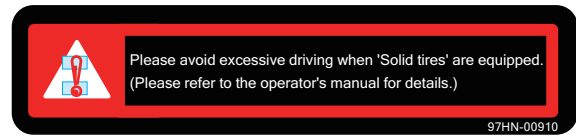

97HN-00910
97HN-00910

1. DIRECTION

The directions of this truck indicate forward, backward, right and left when truck is in the traveling direction.

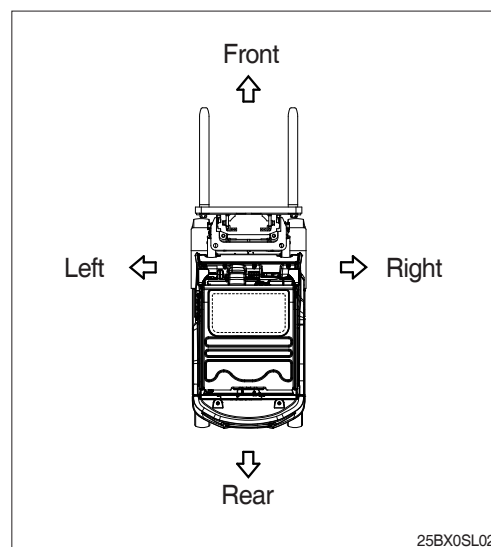

2. SERIAL NUMBER

Inform following when you order parts or the truck is out of order.

1) TRUCK SERIAL NUMBER

It's shown on front of the right side frame.

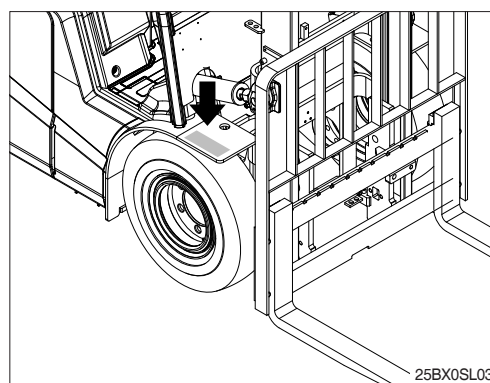

3. SYMBOLS

▲ Important safety hint

△ It indicates matters which can cause the great loss on the truck or the surroundings.

※ It indicates the useful information for operator.

4. VIBRATION ON WHOLE BODY

The vibration level on the whole truck body is measured in accordance with EN13059 standards that contains in-depth testing criteria (e.g., load, speed, and road surface conditions). Vibration level at work-place may vary dependent upon actual work and surface conditions.

- Vibration on whole body is measured at standard production truck mounted with whole suspension sheets in position of operator.
- The truck body vibration was measured in accordance with EN13059.
 - 25/30/32/35B-X: 0.463 m/s²
 - Uncertainty, K=0.2 m/s²